

Snow Foam Application Instructions

www.BOYDHILL.com

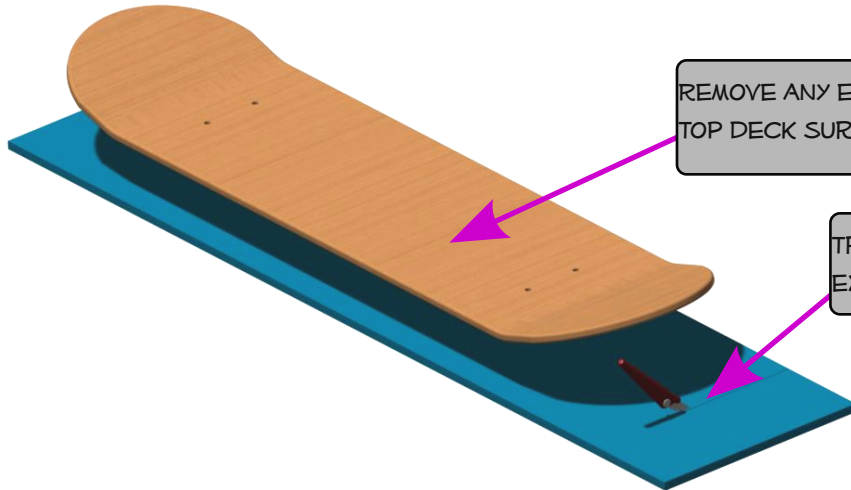

REMOVE ANY EXISTING GRIP TAPE, STICKERS, ETC. AND CLEAN TOP DECK SURFACE WITH ISOPROPYL (RUBBING) ALCOHOL

TRIM SNOW FOAM SHEET TO ROUGH LENGTH - SAVE EXCESS FOR OTHER USES (GRAB RAILS ETC.)

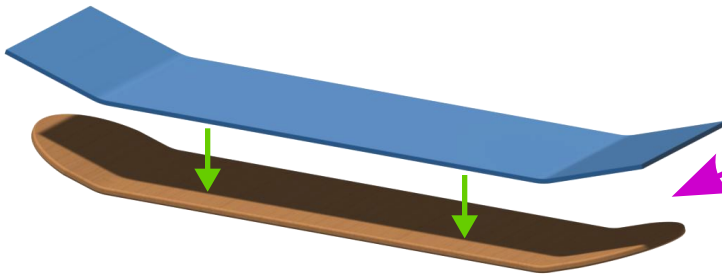

-PEEL BACKING SHEET FROM SNOW FOAM
-PLACE ON TOP OF DECK
-PRESS DOWN FIRMLY, WORKING FROM CENTER OUTWARDS
TIPS:
-PLACE BACKING PAPER ON TOP OF FOAM TO HELP THIS
-PAY EXTRA ATTENTION TO DECK EDGES

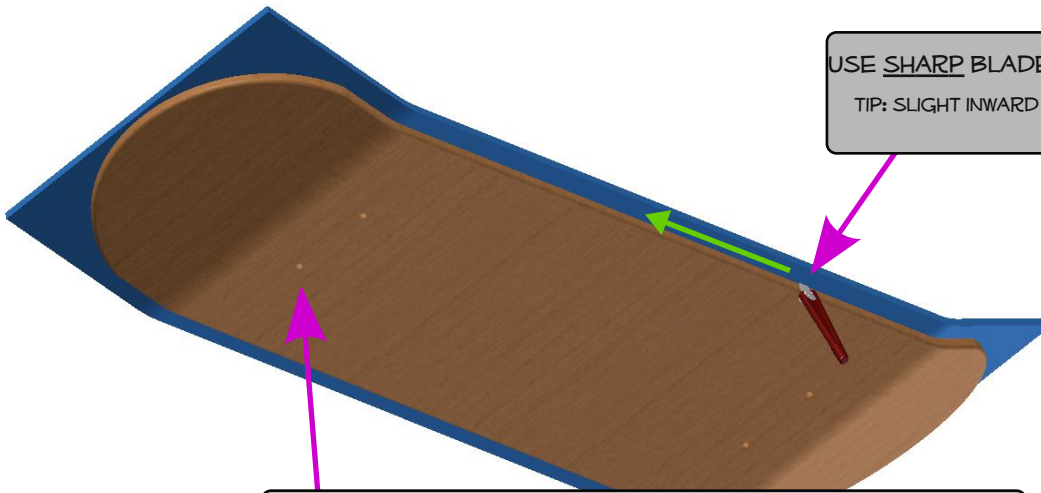

USE SHARP BLADE TO TRIM FOAM TO SHAPE OF DECK
TIP: SLIGHT INWARD LEANING ANGLE OF BLADE WORKS BEST

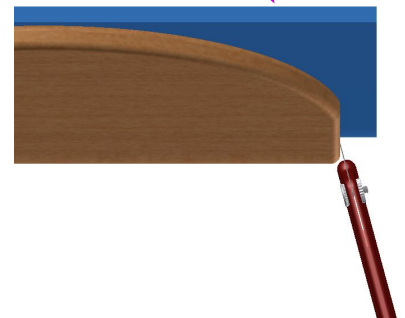

USE POINTY OBJECT (DRILL BIT WORKS WELL) TO MAKE HOLES THRU FOAM FROM BELOW FOR TRUCK MOUNTING BOLTS

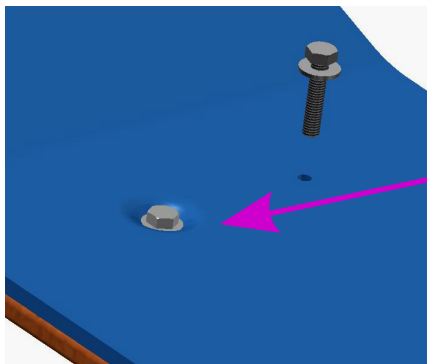

USE WASHER UNDER BOLT HEADS TO SQUEEZE SNOWFOAM DOWN AS SHOWN

